



BG-LVPTZ Series

Designed for flexibility, reliability, and performance, BZBGEAR's LVPTZ series cameras feature powerful lenses in 12X, 20X or 30X optical zoom. A robust selection of connections ensure compatibility with a wide range of equipment. Video with maximum resolution of 1080P 60fps is available simultaneously on HDMI, 3G-SDI and IP Streaming over LAN connection. Variable control options includes RS232, RS485, IP, IR and WebGUI. Audio Embedding is available through the 3.5mm audio input jack.

Utilizing advanced ISP processing algorithms this camera delivers fast, accurate, and stable auto-focusing. By eliminating the need for a power supply, installation and placement have been simplified with PoE functionality via a Cat5/6/7 cable consolidating both A/V signals and power.

These outstanding features make this camera a great choice for environments as diverse as Houses of Worship, Schools, Studios, Event Facilities, and Presentation rooms.

Package Contents

- | | |
|---------------------------|-------------------------|
| 1 x BG-LVPTZ | 1 x RS232 Control Cable |
| 1 x 12V/1.5A Power Supply | 1 x IR Remote Control |
| 1 x User Manual | |

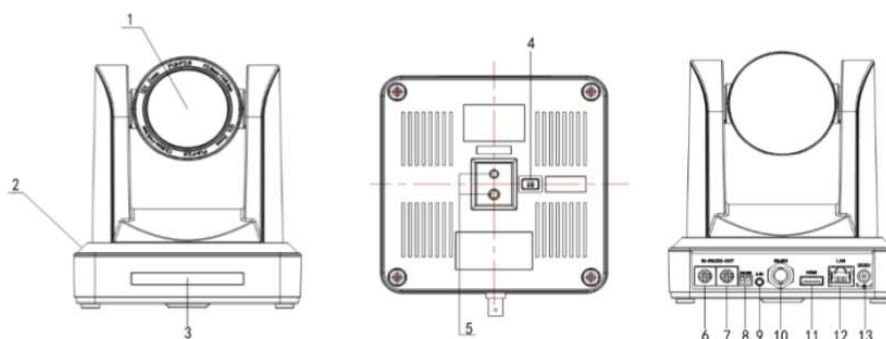

Figure 1.1 Interface

1. Camera Lens
2. Camera Base
3. Remote Controller Receiver Light
4. Bottom Dial Switch
5. Tripod Screw Hole
6. RS232 Control Interface (input)
7. RS232 Control Interface (output)
8. RS485 Input (left +, right-)
9. Audio Input Interface
10. 3G-SDI interface
11. HDMI Interface
12. 10/100M NDI/LAN Network Interface
13. DC12V Input Power Supply Socket



Mounting Instructions

1) Wall mount guide

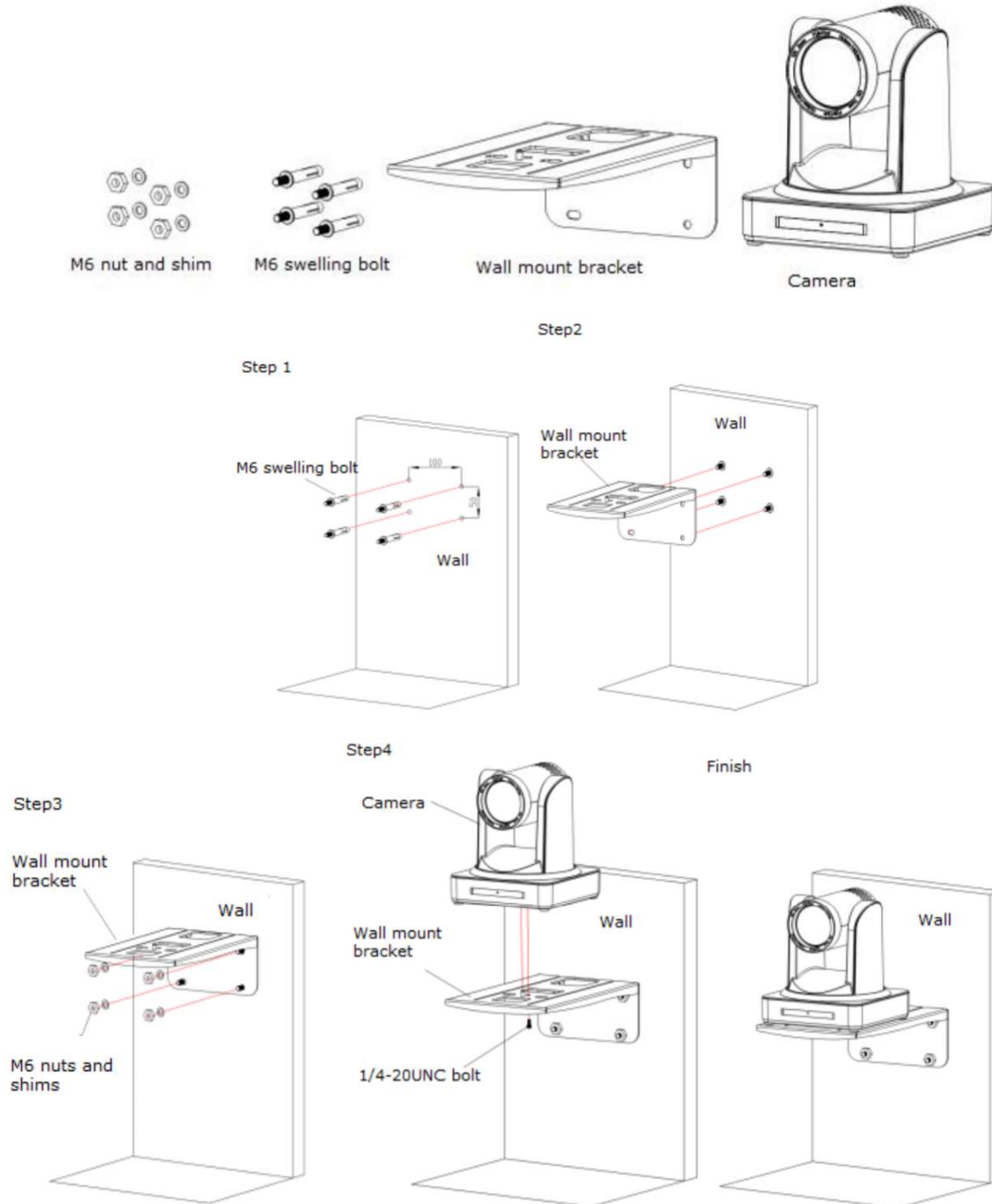

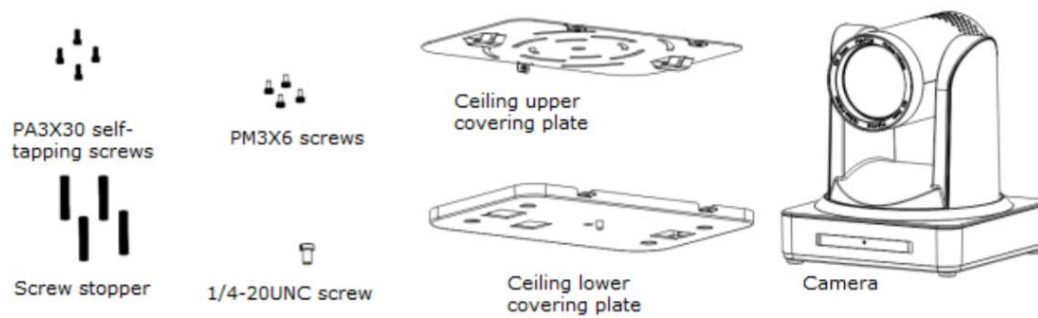
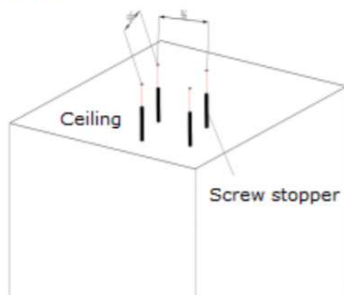
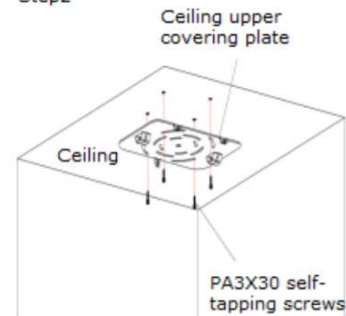
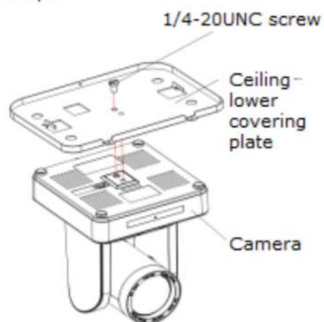
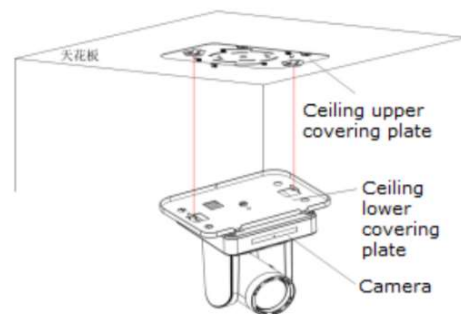
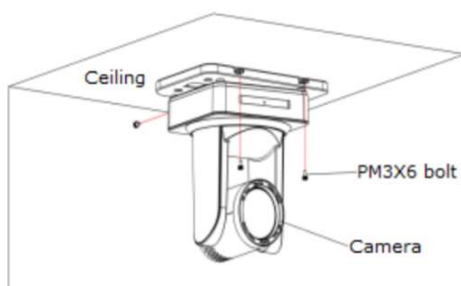
**2. Ceiling mount guide****Step1****Step2****Step3****Step4****Step5**



RS-232 Interface

1) RS-232C interface specification as shown below

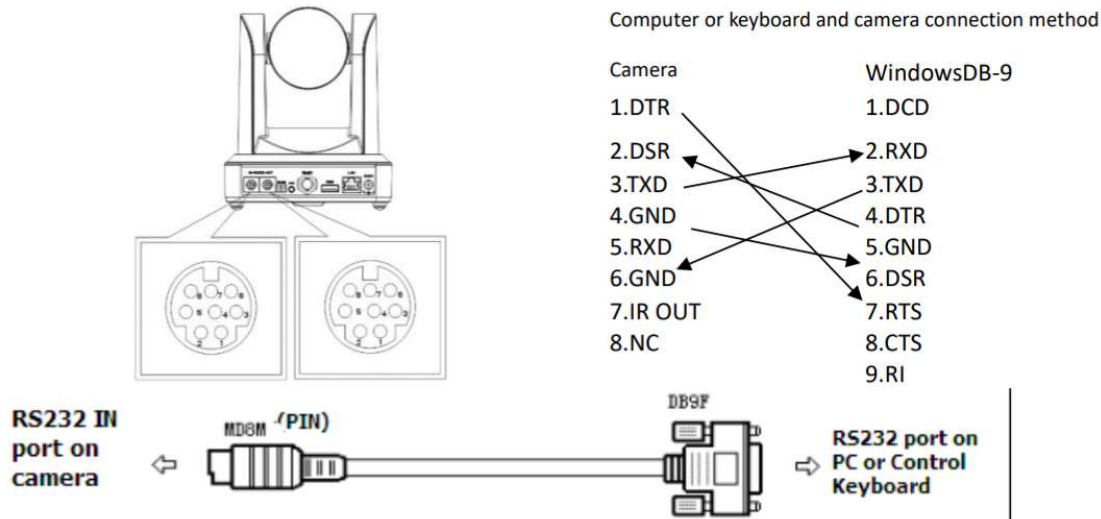

2) RS-232 Mini-DIN 8-pin Port Definition

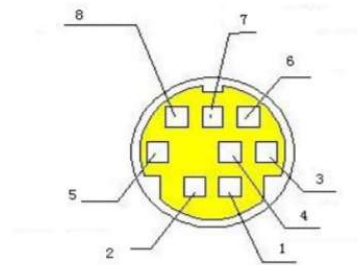

NO.	Port	Definition
1	DTR	Data Terminal Ready
2	DSR	Data Set Ready
3	TXD	Transmit Data
4	GND	System Ground
5	RXD	Receive Data
6	GND	System Ground
7	IR OUT	IR Commander Signal
8	NC	No Connection

WebGUI

The BG-ND camera includes a built-in WebGUI allowing for control and management of advanced features. Use the following instructions to access the WebGUI.

1. Launch a web browser and enter the IP address of the unit (default 192.168.5.163).
2. The BZBGEAR login page will appear.
3. Enter your login information (by default **Username** = admin **Password** = admin).
4. Select the Login button.

Problems connecting to your camera?

Check out our Knowledge Base at <https://bzbgear.com/knowledge-base/> for more information and step-by-step guide.



My camera has no picture	Power is off, bad connection, incompatible resolution, camera lens is obstructed	<ul style="list-style-type: none">• Check the power connection on the back of the camera• Check connections/replace cables with new ones• Use IR remote or WebGUI to change to a resolution that is compatible with your display• Check computer and program settings to ensure USB is discovered
My IR remote control doesn't work	The camera's IR sensor is blocked, batteries are dead, sunlight is interfering with the IR signal	<ul style="list-style-type: none">• Ensure you have a clear line of sight from the remote to the front of the camera base• Replace the batteries• Ensure the camera is out of direct sunlight
I cannot access the camera's WebGUI	The camera is not connected to the network	<ul style="list-style-type: none">• Check connections• Verify your camera's IP address using an IP scanning tool• Ensure your computer is connected to the same network as the camera